

12
mm

Metal
五金



ZWMD012012

齿轮箱规格 Gearbox specifications

外径 Outer diameter	12mm	轴承 Bearing	烧结轴承 Porous Bearing	滚动轴承 Rolling bearing
材质 Material	五金 Metal	轴向窜动 Axial endplay	≤0.3mm	≤0.2mm
旋转方向 Direction of rotation	cc & ccw	输出轴径向负载 Radial loading on output shaft	≤10N	≤20N
齿轮箱回程差 Gear backlash	≤3°	工作温度 Operating temperature range	-20 ~ +85°C	

齿轮级数 Gearbox stages

	1	2	3	4
传动比 Transmission ratio	4 / 6	16 / 24 / 36	64 / 96 / 144 / 216	256 / 384 / 576 / 864 / 1296
最大容许扭力 (gf.cm max) Max rated torque of gear box	300	1000	1500	2000
瞬间容许力矩 (gf.cm max) Instant torque of gear box	4500	4500	4500	5000
齿轮箱效率 Gearbox efficiency	87	74	63	56
长度 Length	12.4	16.2	20	23.8

推荐产品 | RECOMMENDED PRODUCTS

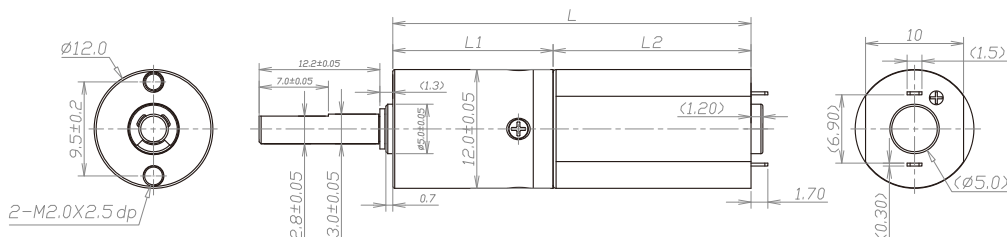

马达规格参数 Motor specifications

马达(可选择) Motors(Optional)	直流有刷电机、直流无刷电机、步进电机 DC brush motor, DC brushless motor, Stepper motor	输入速度 Input speed	≤30000rpm
电压(可选择) Voltage(Optional)	3-24V	电流 Current	250MA max

型号 Model	Rated Speed 额定转速	Max Speed 最高转速	Max Rated Torque 额定容许力矩	Max Instant Torque 瞬间容许力矩	Gear Ratio 减速比	Length 减速箱长 L1	Overall Length 总长 L
	rpm	rpm	gf.cm	gf.cm		mm	mm
ZWMD012012-4	1875	7500	300	4500	4	12.4	32.4
ZWMD012012-6	1250	5000	300	4500	6		
ZWMD012012-16	469	1875	1000	4500	16	16.2	36.2
ZWMD012012-24	313	1250	1000	4500	24		
ZWMD012012-36	208	833	1000	4500	36		
ZWMD012012-64	117	469	1500	4500	64	20	40
ZWMD012012-96	78	313	1500	4500	96		
ZWMD012012-144	52	208	1500	4500	144		
ZWMD012012-216	35	139	1500	4500	216		
ZWMD012012-256	29	117	2000	5000	256		
ZWMD012012-384	20	78	2000	5000	384	23.8	43.8
ZWMD012012-576	13	52	2000	5000	576		
ZWMD012012-864	9	35	2000	5000	864		
ZWMD012012-1296	6	23	2000	5000	1296		